

Wheelhouse Replacement (Front)

Removal Procedure

1. Remove all related panels and components in the area of the damaged apron extension (1).
2. Restore as much of the damage as possible to factory specifications.
3. Note the location and remove the following as necessary:
 - Anti-corrosion materials
 - Sound deadeners
 - Sealers

IMPORTANT: Do not damage any inner panels or reinforcements.

4. Locate and drill out all factory welds. Note the number and location of welds for installation of the service part.

5. Remove the damaged apron extension.

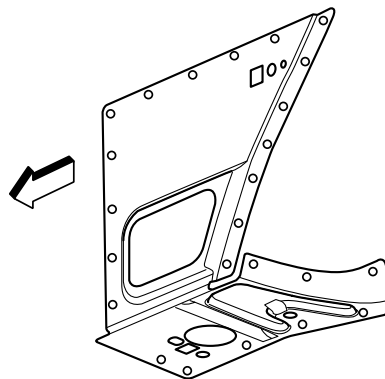
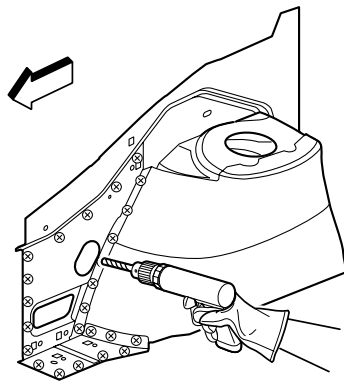
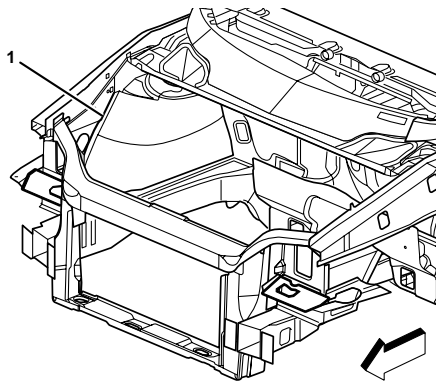

Wheelhouse Replacement (Front)

Installation Procedure

IMPORTANT: In any area damaged beyond recognition, space plug weld holes every 40 mm (1-1/2 in) apart.

1. Drill 8 mm (5/16 in.) plug weld holes in the service part as necessary in the locations noted from the original panel.
2. Prepare all attachment surfaces as necessary.

IMPORTANT: Prior to refinishing, refer to the publication GM4901M-D-01 GM Approved Refinish Materials for recommended products. Do not combine paint systems. Refer to paint manufacturer's recommendations.

3. Apply weld-thru primer to all bare metal surfaces.
4. Position the apron extension.
5. Plug weld accordingly.
6. Clean and prepare all welded surfaces.

7. Apply the following as necessary:
 - Anti-corrosion materials
 - Sound deadening materials
 - Sealers
8. Refinish as necessary.
9. Install all related panels and components.

