

2. Radiator Support Assembly

The radiator support assembly can be serviced as a complete assembly. The radiator support assembly is made up of five major components: four upper and one lower (figure 2-1).

Upper Radiator Support

The upper radiator support is an assembly consisting of four components: a two-piece upper tie bar, and left and right engine compartment front panels.

Lower Radiator Support

The lower radiator support is available as a separate replaceable component if necessary.

Headlight Mounting Brackets

The headlight mounting brackets are available and serviced separately. Using three-dimensional measuring equipment, locate and mark the headlight mounting holes. Drill the holes as necessary.

Radiator Support Assembly Replacement

Remove or Disconnect

1. Remove all related panels and components.
2. Visually inspect and restore as much of the damage as possible to factory specifications.
3. Remove sealers and anti-corrosion materials as necessary.
4. Locate, mark, and drill out all factory welds. Note the number and location of welds for installation of the service assembly.
5. Remove the damaged radiator support assembly.

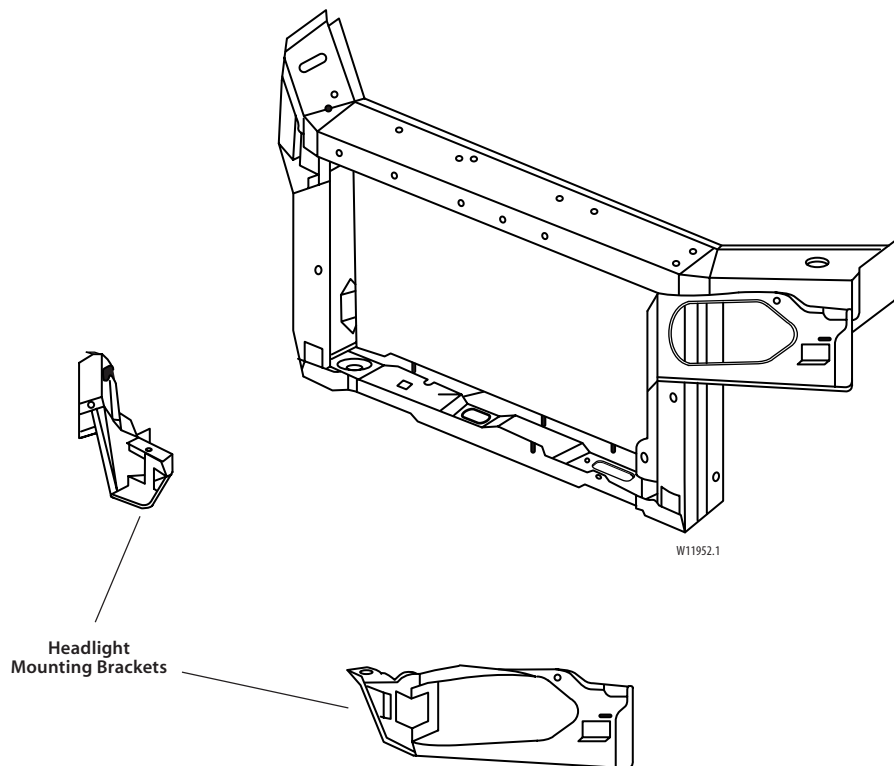

Figure 2-1:
Radiator Assembly

**Radiator Support Assembly
Replacement (cont'd)**

Install or Connect

1. Prepare the mating surfaces as necessary, and check for proper fit of the service panel.
2. Drill 8mm ($\frac{5}{16}$ inch) plug weld holes as necessary in the locations noted from the original assembly.
3. Position the service panel using three-dimensional measuring equipment, plug weld accordingly with frequent measurements to ensure proper fit and alignment.
4. Clean and prepare all welded surfaces. Prime with two-part catalyzed primer. Apply sealers and anti-corrosion protection materials as necessary. Do not combine paint systems. Refer to paint manufacturer's recommendations.
5. Install all related panels and components.