

## Structure Identification

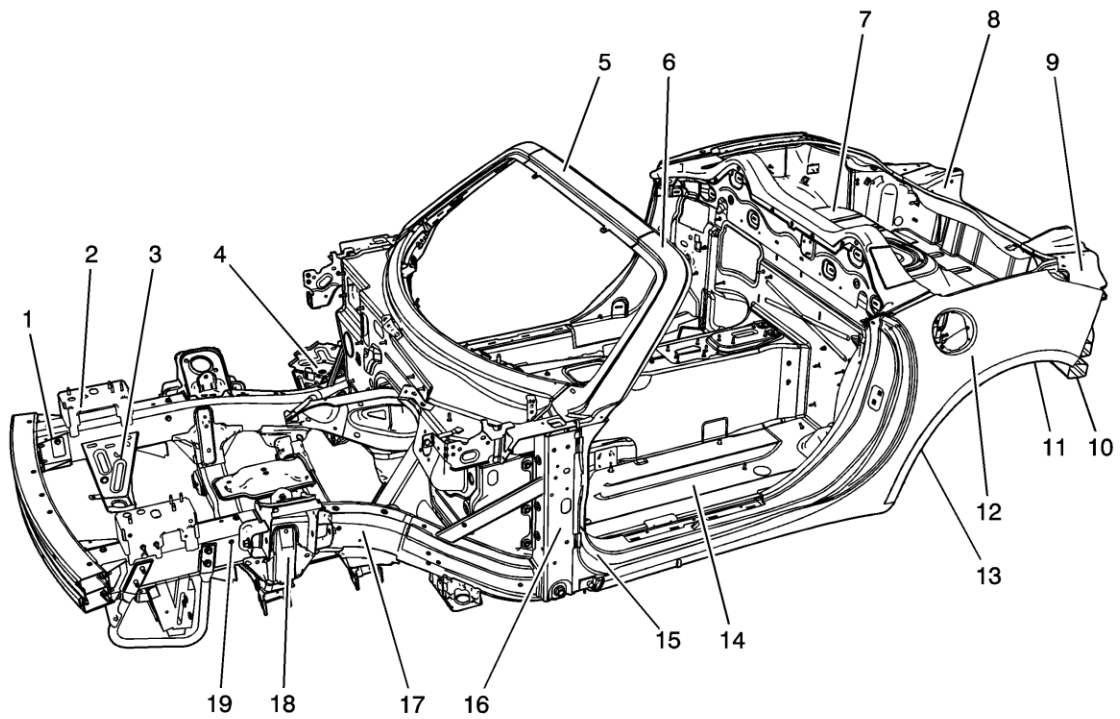

<b>Number</b>	<b>Description</b>	<b>Material</b>	<b>Procedure</b>
1	Front Impact Bar	<a href="#"><u>High Strength Low Alloy Steel</u></a>	<a href="#"><u>Front Bumper Impact Bar Bracket Replacement</u></a>
2	Hood Hinge Bracket	<a href="#"><u>High Strength Low Alloy Steel</u></a>	<a href="#"><u>Hood Hinge Bracket Replacement</u></a>
3	Radiator Lower Support	<a href="#"><u>Mild Steel</u></a>	<a href="#"><u>Radiator Lower Support Replacement</u></a>
4	Battery Tray	<a href="#"><u>High Strength Low Alloy Steel</u></a>	<a href="#"><u>Battery Tray Replacement</u></a>
5	Windshield Panel Upper	<a href="#"><u>Mild Steel</u></a>	<a href="#"><u>Windshield Frame Header Front Panel Replacement</u></a>
6	Windshield Panel Replacement - Lower	<a href="#"><u>Mild Steel</u></a>	<a href="#"><u>Windshield Lower Panel Replacement</u></a>
7	Rear Compartment Panel	<a href="#"><u>Sheet Molding Compound (SMC) Panel Bonding</u></a>	<a href="#"><u>Rear Compartment Panel Replacement</u></a>
8	Rear End Panel	<a href="#"><u>Mild Steel</u></a>	<a href="#"><u>Rear End Panel Replacement</u></a>
9	Quarter Panel Filler	<a href="#"><u>Mild Steel</u></a>	<a href="#"><u>Quarter Panel Filler Replacement - Lower</u></a>
10	Rear Impact Bar	<a href="#"><u>Ultra High Strength Steel</u></a>	<a href="#"><u>Rear Bumper Impact Bar Replacement</u></a>
11	Rear Rail End	<a href="#"><u>Dual Phase Steel</u></a>	<a href="#"><u>Rear Rail End Replacement</u></a>
12	Quarter Panel	<a href="#"><u>Mild Steel</u></a>	<a href="#"><u>Quarter Outer Panel Replacement</u></a>
13	Rear Rail Section	<a href="#"><u>Dual Phase Steel</u></a>	<a href="#"><u>Rail Replacement - Rear Section</u></a>
14	Floor Panel	<a href="#"><u>Mild Steel</u></a>	<a href="#"><u>Floor Panel Replacement</u></a>
15	Front Hinge Pillar Reinforcement	<a href="#"><u>Mild Steel</u></a>	<a href="#"><u>Front Hinge Pillar Body Reinforcement Replacement</u></a>
16	Front Hinge Pillar	<a href="#"><u>High Strength Low Alloy Steel</u></a>	<a href="#"><u>Front Hinge Pillar Body Replacement</u></a>
17	Front Rail Section	<a href="#"><u>Dual Phase Steel</u></a>	<a href="#"><u>Rail Replacement - Front Section</u></a>
18	Front Suspension Crossmember	<a href="#"><u>High Strength Low Alloy Steel</u></a>	<a href="#"><u>Front Suspension Crossmember Replacement</u></a>
19	Front Rail End	<a href="#"><u>Dual Phase Steel</u></a>	<a href="#"><u>Front Rail End Replacement</u></a>

